

ENROLMENT FORM

IVE Engineering

Your Partner in Professional Development



Member of VTC Group
VTC 機構成員

EDiT, B322, 20 Tsing Yi Road, Tsing Yi Island, NT, HK F: 3475 0845 E: EDiT@vtc.edu.hk

Course Title:	Introduction to Structural Analysis and Design by SAP2000	Course Code:	1011-8
Class Schedule:	20/6/2020 (Sat) (1:00 – 7:00 pm) & 22/6/2020 (Mon) (7:00 - 10:00 pm)	Deadline of Application:	05 Jun 2020

Personal Particulars

Name: (should be the name shown on HKID/Passport)	(English Name, Family Name first)	(Chinese)	
HKID/Passport No.:	()	Birthday:	(dd / mm / yy)
Correspondence Address:		Office Phone:	
		Mobile Phone:	
		Fax:	
Email Address:			

Academic and Professional Qualifications (The highest qualification first.)

Year	Academic Institution/Professional Body	Academic Award/Professional Qualification

Working Experience (The most recent first)

Date of Employment (mm/yy to mm/yy)	Name of Company	Position and Duties

Fees

Course Fee: crossed cheque of HK\$1180 payable to "Vocational Training Council" (*For full-time IVE student only. Applicants who want to enjoy discounted course fee, copy of valid IVE student card shall be submitted with the completed application form.)	Cheque No. :
--	--------------

Declaration (*Delete where appropriate)

I wish to receive information from VTC (including course information from its member institutions): (Yes / No)*

I declare that the information provided in this form is, to my best knowledge, accurate and complete. I agree to abide by the rules and regulation of IVE if I am admitted to the course. I understand that the information provided in the form will be used by VTC in the admission process, course administration and promotion.	Signature : Date :
---	---------------------------

*Delete as appropriate

(May 2020)

Introduction to Structural Analysis and Design by SAP2000



Member of VTC Group
VTC 機構成員

Course Contents

1. Overview of the computer software
Object Based Graphical Interface. Coordinate systems.
Material properties. Types elements. Joint constraints. Supports conditions. Loading and displacement. Types of analysis.
Display and output.
Capability and limitations of the software.
2. Analysis and design of simple 3-D bridge structures
Idealization and modeling of structure for structural analysis. Loading, dead load, moving load and lateral wind load. Perform static analysis and time history analysis. Interpretation of outputs: deflection, internal force distributions, mode of vibration and frequency. Member selection and optimization.

Teaching and Learning Approaches

- Small class size
- Hands-on computer workshop
- A series of simulated practical structural problems are designed for you to develop the skills in using the software in actual structural analysis and design

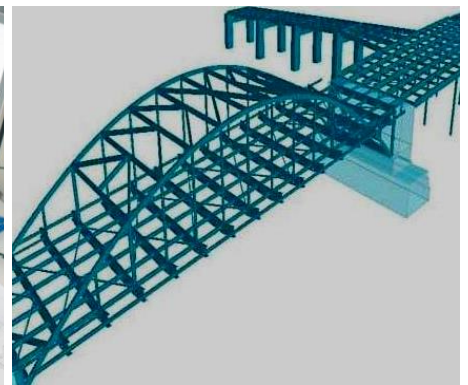
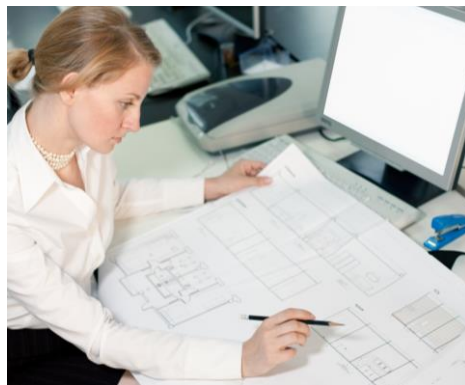

Time and Venue of Classes

- Duration: 9 hrs
- Venue: HK Institute of Vocational Education (Tsing Yi) or, other campuses of IVE

Enquiry

- Tel No.: 2435 9423
- Email: EDiT@vtc.edu.hk
- Website: EDiT.vtc.edu.hk

Fee

- Course fee: HKD\$ 1180

Application

- Apply online or complete the Enrolment Form together with all necessary documents and a crossed cheque for the Course Fee and submit to:
Engineering Discipline In-service Training
HK Institute of Vocational Education (Tsing Yi)
B322, 20, Tsing Yi Rd, Tsing Yi Island, NT

Notes

- Whether the course will be offered depends on the enrolment and is subject to approval by VTC. The applicant will be informed of the timetable one week before the commencement of class. To facilitate communication, the applicant should provide in the Application Form a contact number of mobile phone which can receive SMS messages.